



Danemead, Hoddesdon, EN11 9LT

Offered chain free, this well-presented two-bedroom first-floor maisonette benefits from its own private entrance, a garage, and a private garden, making it an ideal purchase for first-time buyers, investors, or downsizers seeking spacious accommodation with excellent outside space. The property enjoys a remarkably long lease of 944 years with no service charges, adding to its appeal and long-term value. Inside, the maisonette features a welcoming entrance hallway with plumbing for a washing machine and space for a tumble dryer. Stairs lead to first floor and door leading to a bright and generously sized lounge/diner, complemented by an attractive fitted kitchen and a modern bathroom/W.C. There are two double bedrooms, both offering comfortable proportions and ample space. Further benefits include gas central heating, double-glazed windows, and a well-kept private garden providing an excellent area for outdoor dining and relaxation. A superb opportunity to acquire a spacious, low-maintenance home in a convenient location with outstanding lease terms and no onward chain.

Key features

- Chain free, two-bedroom first-floor maisonette with private entrance
- 944-year lease remaining with low service charges
- Spacious lounge/diner
- Two double bedrooms
- Garage and private garden
- Gas central heating and double-glazed windows
- Attractive fitted kitchen and modern bathroom
- Entrance hall with plumbing for washing machine & space for dryer



 **paulwallace**
estate agents

hoddesdon@paulwallace.co.uk

01992 466471





Ground Floor

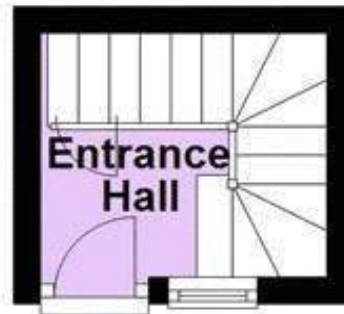

First Floor

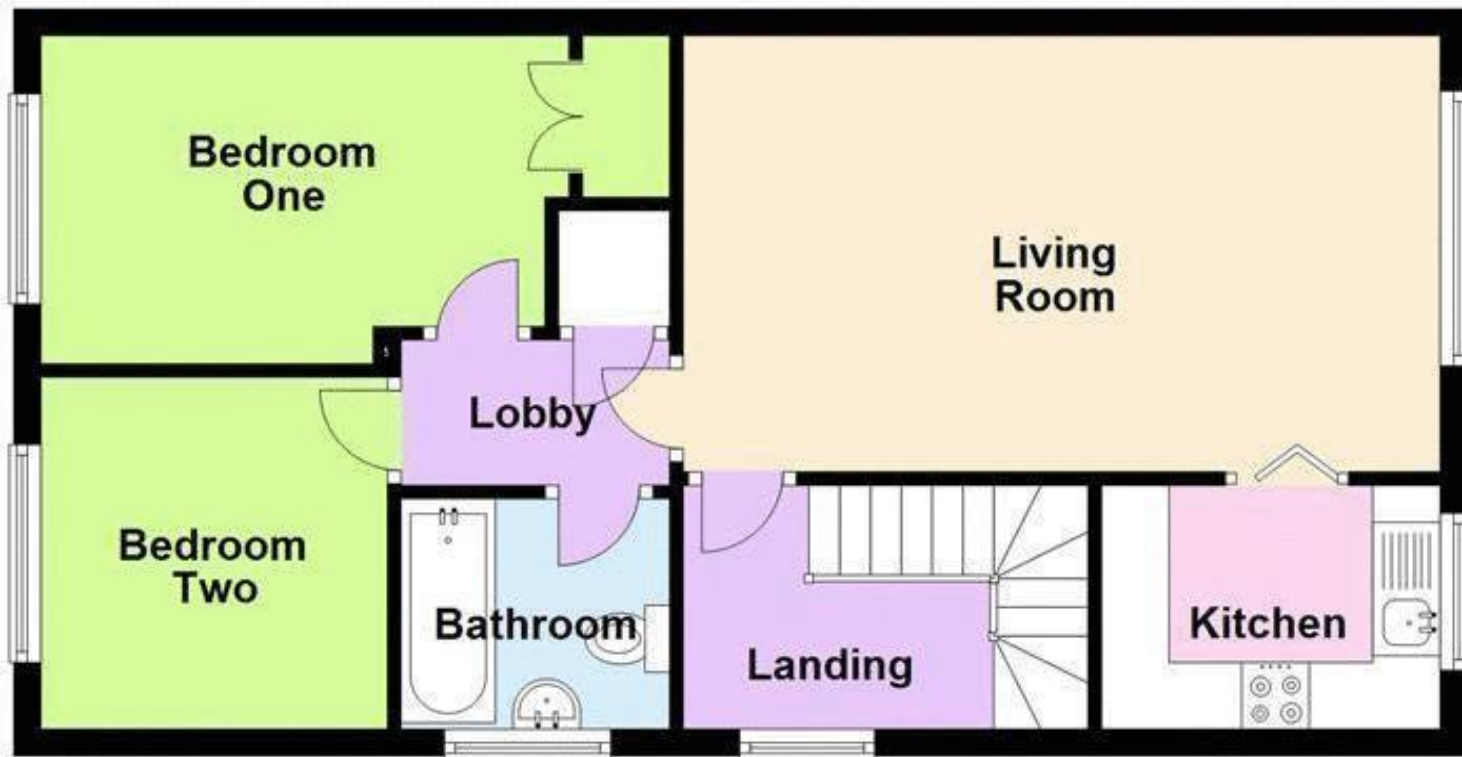



Registered Address: Unit 3 The Brookfield Centre, Cheshunt, Herts, EN8 0NN Company Registration Number: OC414280 | VAT Number: 276958046©2022 Paul Wallace Group LLP trading as Paul Wallace Estate Agents



Paul Wallace Estate Agents

70 High Street
Hoddesdon
Hertfordshire
EN11 8ET



01992 466471



hoddesdon@paulwallace.co.uk



www.paulwallace.co.uk



Opening Times

Mon	9am to 6.30pm
Tues	9am to 6.30pm
Wed	9am to 6.30pm
Thurs	9am to 6.30pm
Fri	9am to 6.30pm
Sat	9am to 5.00pm
Sun	Closed



paulwallace
estate agents

Agents Note: Whilst every care has been taken to prepare these sales particulars, they are for guidance purposes only. All measurements are approximate and are for general guidance purposes only and whilst every care has been taken to ensure their accuracy, they should not be relied upon. Potential buyers are advised to recheck the measurements.